

c. 1820 log house (owner says - it's his family home. Details are early 1800's.)

Porch is old but apparently added - see original pt. between base of porch supports, Hurricane Valley, Madison Co., Ala

Hurricane Valley
E. 2nd St. NW



AMERICAN
VALLEY c. 1820
LOG HOUSE

PHOTOS 1978
HARVEY P. J. Lynn Jones

S.E. front

SW. Wall

pt. ↓

5 ft
Lynn
Jones



1 of 4

front door = 2 bds, strap hinges

S.W. wall

pt. ↓



dr. stair



banded - edge planed joints $\pm 2'$ o.c.
fl. / ceiling.



"HALL" mantel (only one in hall)



++N



Original rafters (pith-sawn,
half-lap of tenon & peg ridge)



Inside of front door
(2 wide bds + 2 battens)
battens
beveled edges
strap hinges



Stair Rail at \$1.2 (Lg ft)



Barn, N.E. corner



log barn, N. wall of yard



Manger $\pm 18^{\circ}$ w. x 6' d.



Shed, N.W.M.
 elderly owner in 1978 says he split
 these roof shingles when a kid,
 using a froe (tool)

John C. BARD
HARRISBURG
VALLEY



Barn - N. part of Harrison's Valley, N.E. Madison Co. AL
W. side of Harr. Valley Rd.

①
looks to be
ca. 1835-50
(check)

P.S. = 1850's.
Brick veneered
& remodeled in
ca. 1985.

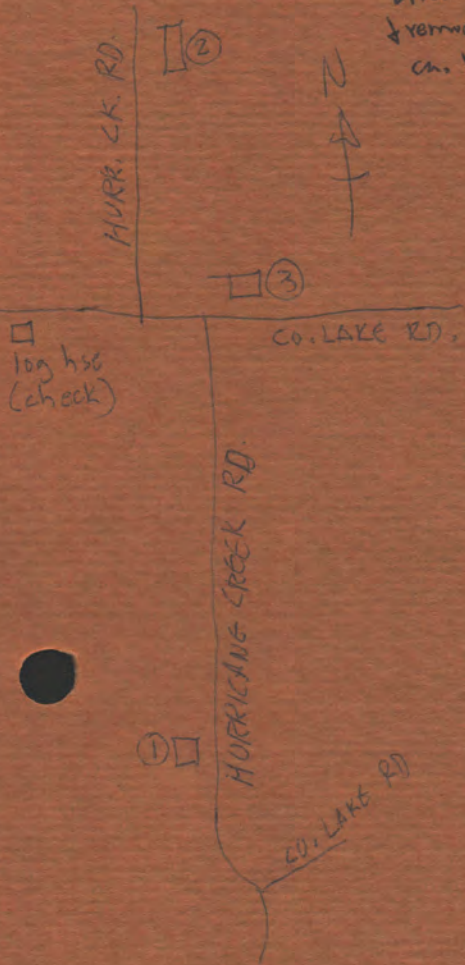

| dogtrot |

is
dogtrot
log hse

③
log,
hse

