

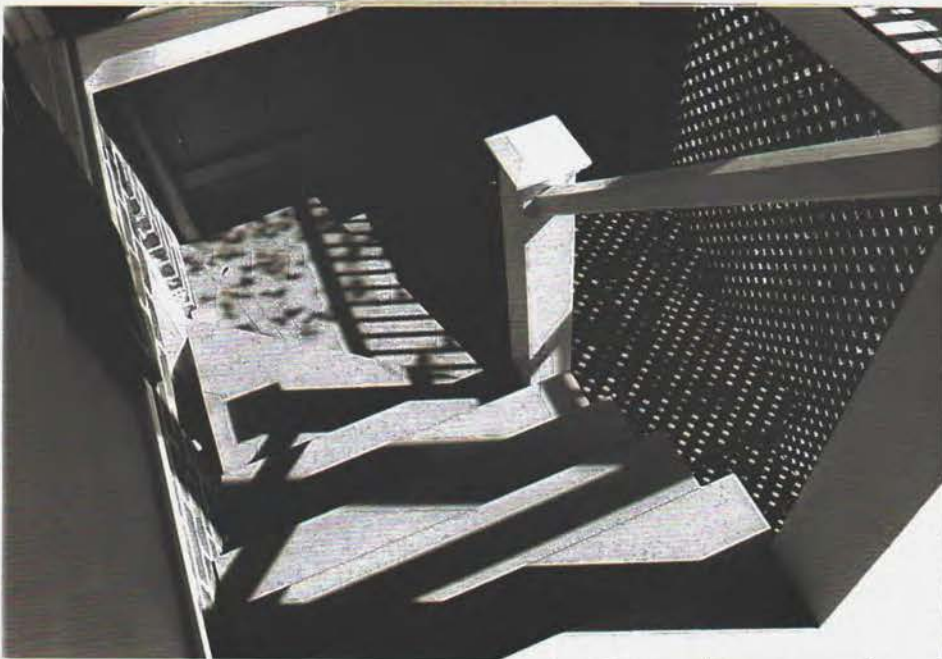

"before" (1970's stair)



~ 1970's stair on side
Verbonden

M/M's house also
(1850's?) *←* same as this

plus (Mar. 1971) *←* same

2 of 4 (Re-do this stair more appropriately)



Redo for smaller panes, wider stile

"before"
(1970's)





↑
↑



↑
↑



3
3





North wing west wall
1840 wall, c.1975 repair, & verandah

A of F



→



←

H Jones redesigned balustrade.
 Also made of hist. inaccurate
 photos April 1991 HPS, FRIA

"after"

Swanwick, Ga.
 Mills Lane Pls. (1850's)

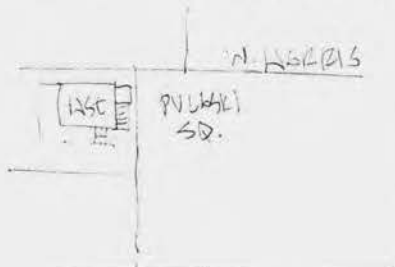

color photo Oct '93 Ralph Anderson

1002



H ←

H. Jones redesigned stairs & balustrade.
Was made 1960's.

"after"



H ←



H ←

2



Redo these for
smaller panes,
wider stiles

Use sim. cabinets in
1810 N. Use at Haberstrom & York 30P4



"before"



Re-do newel
 all the things similar
 to the nearby
 Italianate porch
 look for a more
 appropriate Ek. Revival
 design



Pyrochou fits
 mid 19th c.
 Adams St
 Hill

nearby
 example
 for
 newel
 post





"after"

redesigned 1991 by ADJMS
 (was a c.1975 sq. ft.)
 per Gb. Remond examples on
 similar - period steps.

Also restored c.1975 by
 a Savannah architect,
 now retired

Mrs. Lewis 1849 house
 N. side of Pulaski St.
 Savannah

→ photos ↓





N ←

"after"

Stair design of
 detailed by
 H. Jones, 1990

Mrs Lane Res., West Side
 of Parkside Square Savannah
 photos April 1991 H Jones

Contd. = J. T. Turner Const.
 Supt = Ralph Anderson (gpd)

246



N ←



N ←



1st +
 NMM's Lewis 1849 house, west side
 of Puhalee City, Savannah
 Rear remodeled (not original)
 built c. 1975 (c) photos April 1991
 120 NMM

Z4



not built.
 Did lattice
 only
 photos from space in 1991
 photos by John (NMM)

Z4



Z4

Z4



To Hill

→

P to Din.



→

West (over) view



→

2



→