

Frances Cabaniss Roberts Collection: Series 7, Box 3, Folder 1
Dekalb County, Alabama Map and Aerial Photograph Identification

Image 1 r07_03-01-000-5793 [Contents](#) [Index](#) [About](#)

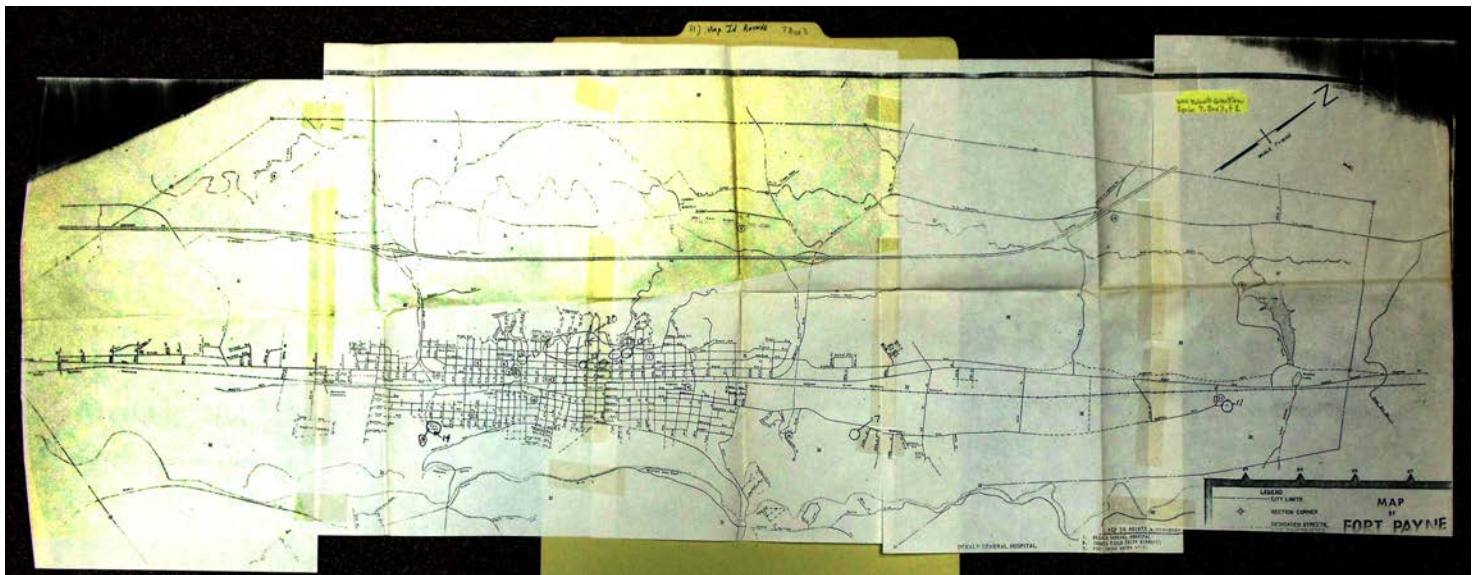

hospital, airport, water works

Names:

Fort Payne, AL

Places:

Dekalb Co., AL

Types:

map

Frances Cabaniss Roberts Collection: Series 7, Box 3, Folder 1
DeKalb County, Alabama Map and Aerial Photograph Identification
Image 2 r07_03-01-000-5794 [Contents](#) [Index](#) [About](#)

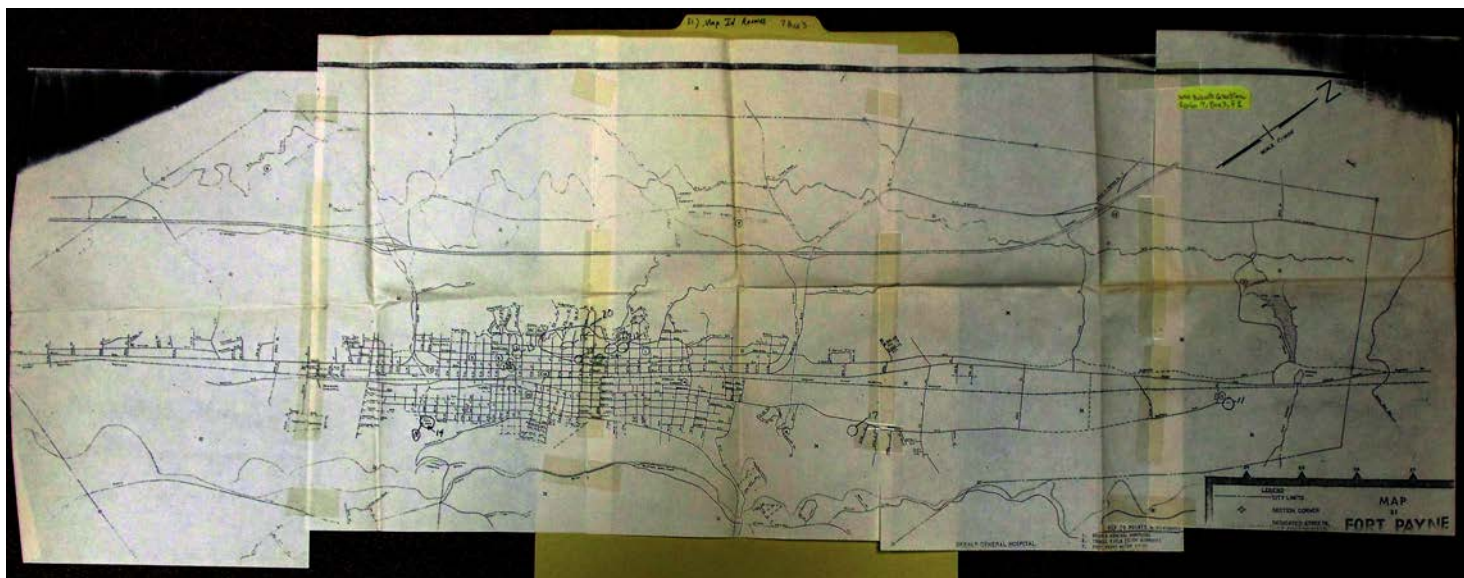

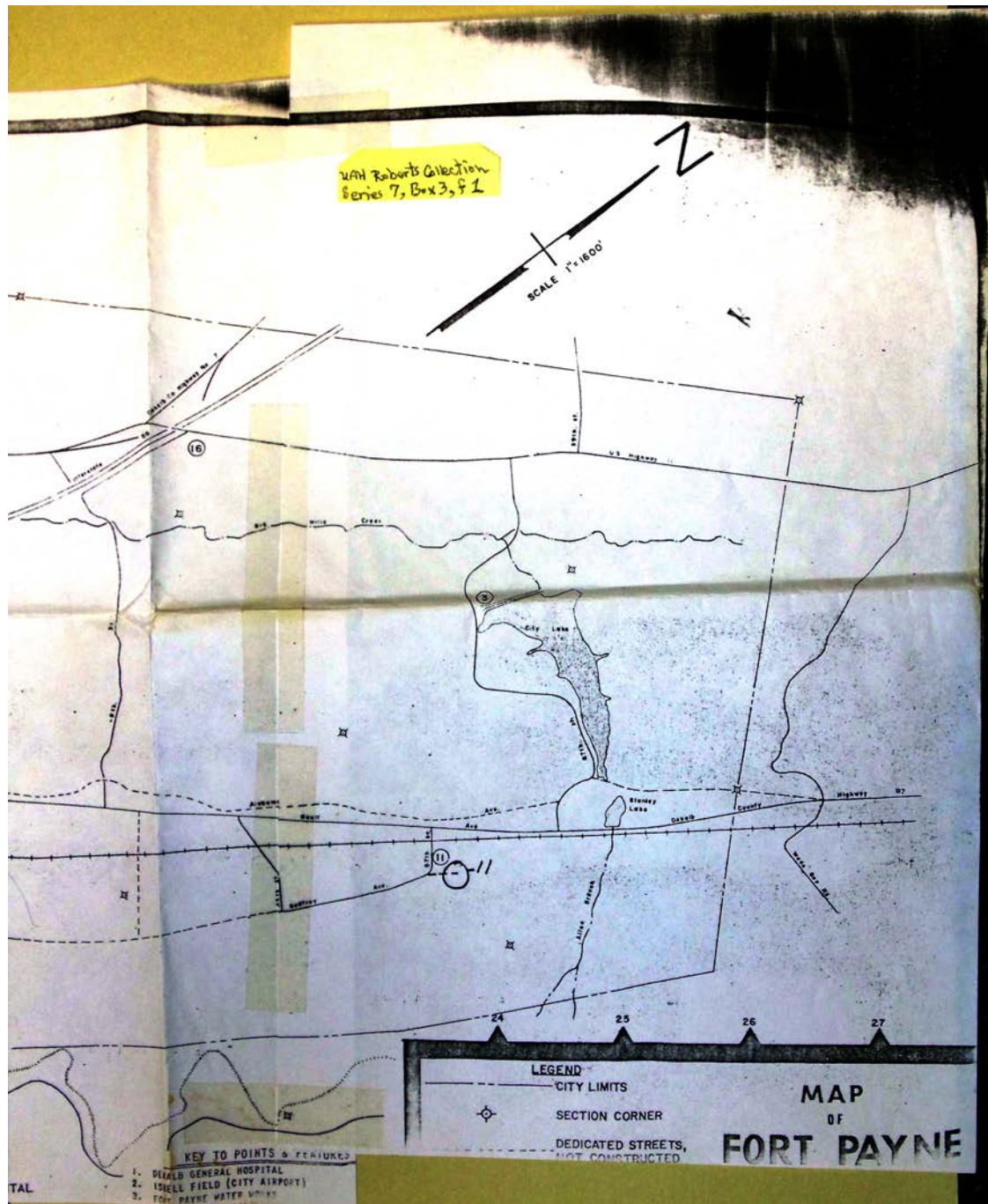

city limits, streets

Names:

Fort Payne, AL

Places:

DeKalb Co., AL

Types:

map

Frances Cabaniss Roberts Collection: Series 7, Box 3, Folder 1
DeKalb County, Alabama Map and Aerial Photograph Identification
Image 4 r07_03-01-000-5796 [Contents](#) [Index](#) [About](#)

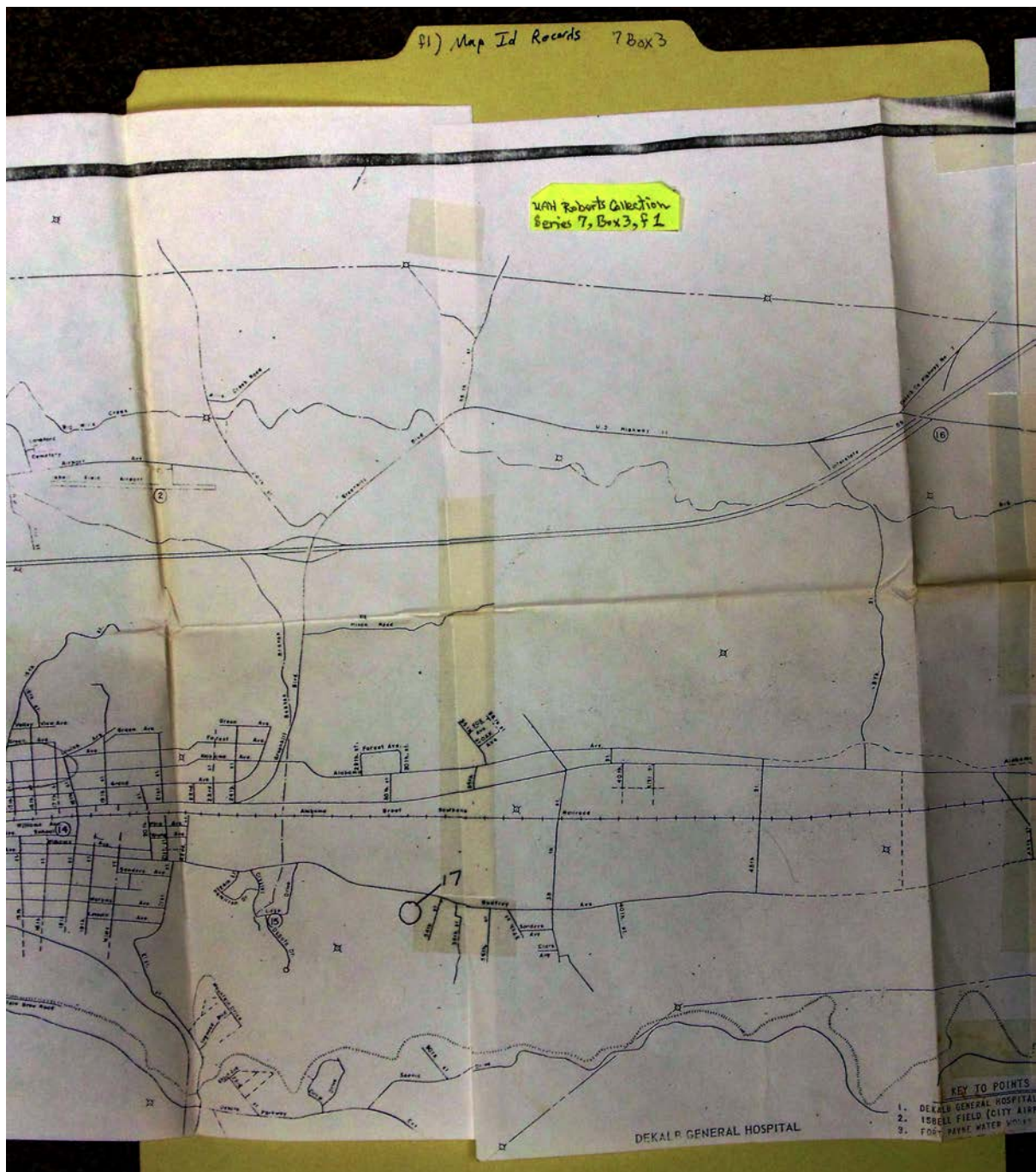

hospital, airport, water works

Names:

Fort Payne, AL

Places:

DeKalb Co., AL

Types:

map

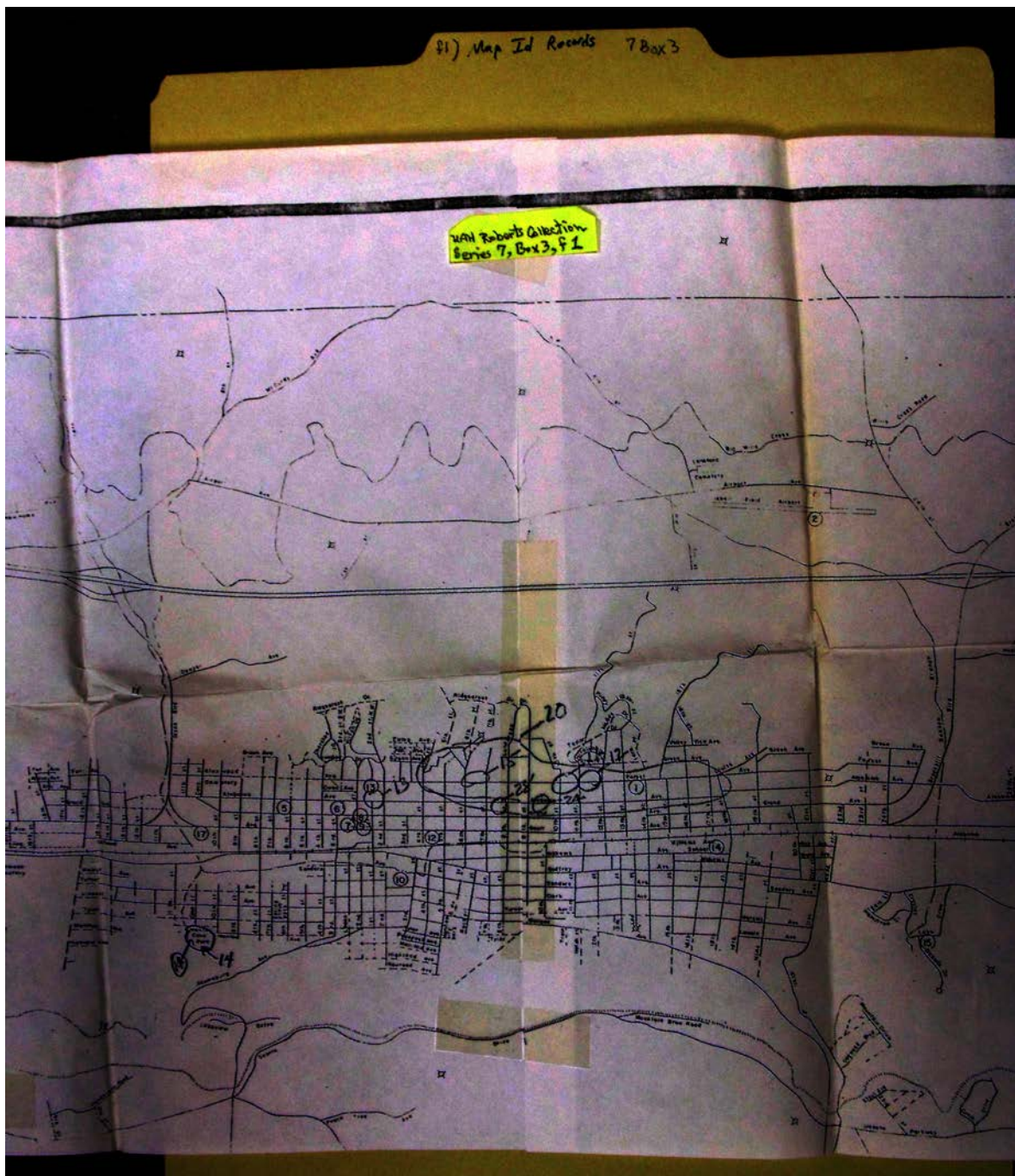

Names:

Fort Payne, AL

Places:

DeKalb Co., AL

Types:

map

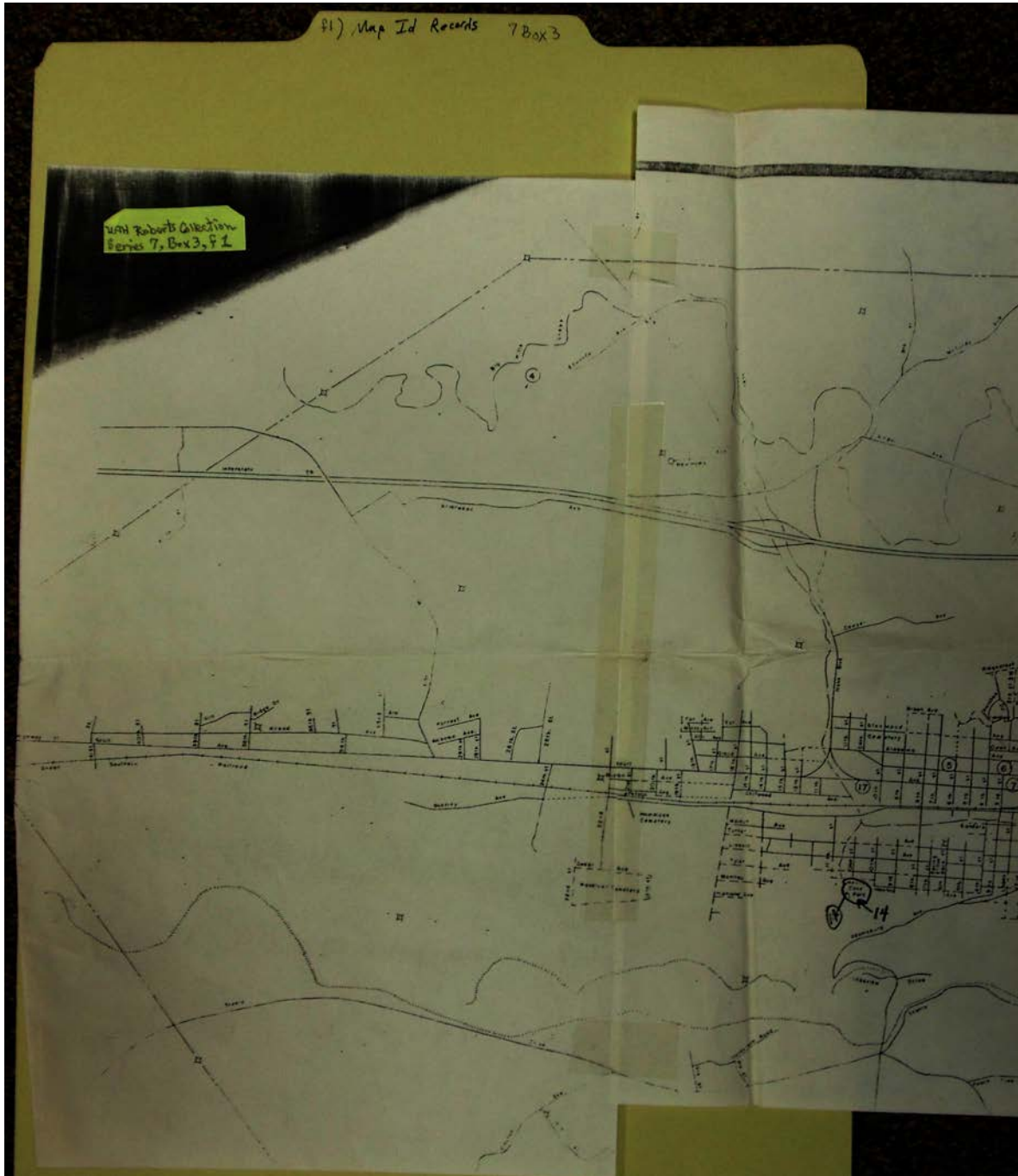

Names:

Fort Payne, AL

Places:

DeKalb Co., AL

Types:

map

#1) Map Id Records 7 Box 3

MAP AND AERIAL PHOTOGRAPH
IDENTIFICATION

81:1:17

TITLE: "La Tourette's Map of the State of Alabama and West Florida"

DESCRIPTION:
 Date- 1856
 Publisher, Lithographer, Surveyor, (Geographer (circle))-
 John La Tourette
 Size- 50" X 57"
 Items on Legend- Rail Road, Plank Road, Swamps, Dividing
 Bridges
 Scale- 1" = 6 miles
 Area Covered-
 Alabama
 Condition-
~~Good~~ Good

SIGNIFICANCE:
 Excellent ~~and~~ and detailed map ~~for~~ ^{drafted} "for the purpose of making a correct map of the State of Alabama" its accuracy ~~and detail~~ is unusual for the ~~era~~ era. Includes a map of Huntsville.

LOCATION (Specific library, courthouse, etc.):
 The Rucker Agee Collection
 Birmingham Public Library

Topics:

geographer

map includes
Huntsville

Names:

LaTourette, John

Rucker Agee
Collection

Places:

Alabama & west
Florida

Birmingham, AL

Types:

map identification

map notes

Dates:
1856

§1) Map Id Records 7 Box 3

FULL BIBLIOGRAPHICAL CITATION OF SOURCE CONTAINING MAP OR PHOTOGRAPH
(call number included if library source):

OWNERSHIP:
Copy secured courtesy of the library.

(Other information attached)

page 2

Types:

map notes

Dates:

1856

81) Map Id Records 7 Box 3

MAP AND AERIAL PHOTOGRAPH
IDENTIFICATION

81:1:18

TITLE: "Alabama: county and township map"

DESCRIPTION:

Date- 1856
Publisher, Lithographer, Surveyor, Geographer (circle)-
S.E. Moore

Size- 13" x 15"
Items on Legend-
Towns, canals, railroads, common roads, etc.

Scale- 1" = app. 25 miles.
Area Covered-
Alabama

Condition-
Excellent

SIGNIFICANCE:
This 1856 map shows the important
roads, canals, and railroads of the period.

LOCATION (Specific library, courthouse, etc.):
The Frank M. Jones Collection
Birmingham

Names:

Frank M. Jones
Collection

Moore, S. E.

Places:

Alabama

Birmingham, AL

Types:

document

map identification

Dates:

1856

fl) Map Id Records 7 Box 3

FULL BIBLIOGRAPHICAL CITATION OF SOURCE CONTAINING MAP OR PHOTOGRAPH
(call number included if library source):

OWNERSHIP:

copy secured, courtesy of Mr. Jones.

(Other information attached)

Types:
map notes

Dates:
1856

81) Map Id Records 7 Box 3

MAP AND AERIAL PHOTOGRAPH IDENTIFICATION

81:1:19

TITLE: "Colton's Alabama"

DESCRIPTION:

Date- 1859

Publisher, Lithographer, Surveyor, Geographer (circle)-
Johnson & Browning

Size- 14" x 16 1/2"

Items on Legend-
railroads, common roads, canals, county
towns, villages, P.O.'s

Scale- 1" = 25 miles

Area Covered-
Alabama

Condition-
good

SIGNIFICANCE:
township map useful in
conjunction with plat books

LOCATION (Specific library, courthouse, etc.):
Library of Congress
Map Division
copy secured

Topics:

Maps Division

publisher

Names:

Browning,

Colton's map of
Alabama

Johnson,

Places:

Library of Congress

Types:

map identification

map notes

Dates:

1859

81) Map Id Records 7 Box 3

MAP AND AERIAL PHOTOGRAPH

TITLE: "Johnson's Georgia and Alabama"

DESCRIPTION:

Size: 17 1/2" x 27"

Publisher: ~~Wm~~ A.J. Johnson, New York

Date: 1863

Items on Legend-

State Capital	Important Places
County Towns	Rail Roads
Cities	Common roads

Scale- 25 mi. to 1"

Area Covered-

Georgia and Alabama

Condition-

Good

SIGNIFICANCE: #1 of Historical interest showing ^{general} location of ~~A~~ sites in North Alabama. Depicts creeks as well as rivers.

~~Where Located:~~ (Specific Library, Courthouse, etc.):

Heritage Room of Huntsville Public Library

HM 2-20 (2 maps)

Full Bibliographical citation of source containing map or photograph (call number included if library source):

OWNERSHIP:

~~Huntsville Public Library~~

(Other information attached)

publisher

Names:

Johnson, A. J.

Johnson's Georgia
and Alabama

Places:

Huntsville, AL

New York

Types:

map identification

map notes

Dates:

1863

#1) Map Id Records 7 Box 3

MAP AND AERIAL PHOTOGRAPH
IDENTIFICATION *N. Ala. only*

81:1:20

TITLE: "Colton's Map of the State of Alabama"

DESCRIPTION: ~~None~~ *added*
 Publisher, Lithographer, Surveyor, Geographer (circle)-
G. W. & C. B. Colton & Co.

Size- 30" x 38"
 Items on Legend-
none

Scale- 1" = 10 miles
 Area Covered-
Alabama

Condition-
good

SIGNIFICANCE: *detailed topographic and township map of the area; excellent for use with plat books*

LOCATION (Specific library, courthouse, etc.):
*Library of Congress
 Map Division
 copy secured*

Topics:

north Alabama only

Map Division

publisher

Names:

Colton, C. B.

Colton's map of
Alabama

Colton, G. W.

Places:

Library of Congress

Types:

map identification

map notes

Image 14 r07 03-01-000-0009 [Contents](#) [Index](#) [About](#)

Topics:

surveyor,
superintendent

U. S. Construction
survey

Alabama

Bache, A. D.

Library of Congress

map identification

map notes

1865

81) Map Id Records 7 Box 3

B1:1:1122

MAP AND AERIAL PHOTOGRAPH
IDENTIFICATION

TITLE: "Asher & Adams' Georgia & Alabama"

DESCRIPTION:

Date- 1872

Publisher, Lithographer, Surveyor, Geographer (circle)-
Asher and Adams

Size- 18" x 26"

Items on Legend-
None

Scale- 1" = 20 mi.

Area Covered-
Alabama and Georgia

Condition- Good

SIGNIFICANCE: Excellent map of the period showing all
important settlements and railroad.

LOCATION (Specific library, courthouse, etc.):
The Rucker Agee Collection
Birmingham Public Library

Topics:

Georgia and Alabama
map

geographer

Names:

Adams,
Asher,

Rucker Agee
Collection

Places:

Birmingham, AL

Types:

map identification

map notes

Dates:

91) Map Id Records 7 Box 3

FULL BIBLIOGRAPHICAL CITATION OF SOURCE CONTAINING MAP OR PHOTOGRAPH
(call number included if library source):

OWNERSHIP:

Copy secured courtesy of the library.

(Other information attached)

page 2

Types:

map notes

81) Map Id Records 7 Box 3

MAP AND AERIAL PHOTOGRAPH

TITLE: *"DeKalb County" Map of the States of Georgia and Alabama*

DESCRIPTION:
Size: *15" x 23"*
Published: *entered according to Act of Congress in the T. of C.*
Date: *1872*
Items on Legend- *None*
Scale- *30 mi. to the inch*
Area Covered- *Ala. & Ga.*
Condition- *Good*

SIGNIFICANCE: *Of historic value but N. Ala. region is presented generally.*

~~Where~~ Located: (Specific Library, Courthouse, etc.):
Heritage Room of the Huntsville Public Library, HM 2-21.

Full Bibliographical citation of source containing map or photograph (call number included if library source):

OWNERSHIP:
Huntsville Public Library.

(Other information attached)

Topics:

county maps

publisher

Names:

Georgia and Alabama

Mitchell, S. Augustus

Places:

Huntsville, AL

Types:

map identification

map notes

Dates:

1872

81) Map Id Records 7 Box 3

MAP AND AERIAL PHOTOGRAPH IDENTIFICATION (only H. Ala.)

81:1:23

TITLE: "Post Route Map of the States of Alabama and Mississippi"

DESCRIPTION:

Date- 1876

Publisher, Lithographer, Surveyor, Geographer (circle)-
U. S. Post Office Dept.

Size- 60" x 29"

Items on Legend-
railroad
mail delivery schedules
special supplies

Scale- 1" = 10 miles

Area Covered-
~~Alabama~~ North Ala. section only

Condition-
good

SIGNIFICANCE:
detailed map showing old roads, settlements, and mail service to the region

LOCATION (Specific library, courthouse, etc.):
Library of Congress
Map Division
copy secured

Topics:

post route map of AL
and MS

publisher

Library of Congress,
Map Division

Names:

Alabama and
Mississippi

U. S. Post Office
Department

Types:

map identification

map notes

Dates:

1876

81) Map Id Records 7 Box 3

MAP AND AERIAL PHOTOGRAPH
IDENTIFICATION

81:1:24

TITLE: "Cram's Railroad & Township Map of Alabama"

DESCRIPTION:

Date- 1878

Publisher, Lithographer, Surveyor, Geographer (circle)-
Geo. F. Cram

Size- 17" x 22"

Items on Legend-
none

Scale- 1" = 19 miles

Area Covered-
Alabama

Condition-
good

SIGNIFICANCE:
~~Topographic map for~~
A township map for use with
plat books

LOCATION (Specific library, courthouse, etc.):
Library of Congress
Map Division
copy scanned

Topics:

Map Division

publisher

Names:

Cram, George F.

Cram's Railroad &
Township

Places:

Library of Congress

Types:

map identification

map notes

Dates:

1878

81:1:25

81) Map Id Records 7 Box 3

MAP AND AERIAL PHOTOGRAPH
IDENTIFICATION

TITLE: "Gray's New Map of Alabama"

DESCRIPTION:

Date- 1878

Publisher, Lithographer, Surveyor, Geographer (circle)-
Frank A. Gray

Size- 18" x 29"

Items on Legend-
population indicators
railroads
canals

Scale- 1" = app 12 miles

Area Covered-
Alabama

Condition-
good

SIGNIFICANCE:
detailed township map excellent
for use with plat books.

LOCATION (Specific library, courthouse, etc.):

geographer

Names:

Gray, Frank A.

Gray's map of
Alabama

Places:

Alabama

Types:

map identification

map notes

Dates:

1878

Frances Cabaniss Roberts Collection: Series 7, Box 3, Folder 1
Dekalb County, Alabama Map and Aerial Photograph Identification
 Image 21 r07_03-01-000-0016 [Contents](#) [Index](#) [About](#)

81) Map Id Records 7 Box 3

MAP AND AERIAL PHOTOGRAPH

TITLE: "State of Alabama"

DESCRIPTION:

Size: 24" x 32 1/2" Publisher

Date: 1878 by Dept of Int. Gen. Land Office, J.A. Williamson, Commissioner

Items on Legend- U.S. Land Office Principal R.R. Stations R.R.'s completed
State Capital Town and Villages R.R. Land Grant
County Seats Boundary of Counties Limits

Scale- 12 mi to inch

Area Covered- State of Alabama

Condition- Very good

SIGNIFICANCE: Very good map which includes creeks by which many of the sites are located in the

~~Where Located~~ (Specific Library, Courthouse, etc.):
Heritage Room of the Huntsville Public Library.
HM 2-4

Full Bibliographical citation of source containing map or photograph (call number included if library source):

OWNERSHIP: ~~Huntsville Public Library~~

(Other information attached)

Topics:

Department of
Interior

Commissioner

Library's Heritage Room

Names:

Alabama

Williamson, J. A.

Places:

Huntsville, AL

Types:

map identification

map notes

Dates:

1878

81) Map Id Records 7 Box 3

B1:1:626

MAP AND AERIAL PHOTOGRAPH
IDENTIFICATION

TITLE: "Cram's Railroads & Township Map of
Alabama"

DESCRIPTION:
Date- 1879
Publisher, Lithographer, Surveyor, Geographer (circle)-
Geo. F. Cram
Size- 21" x 13"
Items on Legend- None
Scale- 19 miles = 1 in.
Area Covered- Alabama
Condition- Good

SIGNIFICANCE: Excellent late nineteenth century map
depicting the location of all the railroads
and important towns within the region.

LOCATION (Specific library, courthouse, etc.):
The Rucker Agee Collection
Birmingham Public Library

Topics:

publisher

township map of
Alabama

Names:

Cram, George F.
Cram's railroads

Rucker Agee
Collection

Places:

Birmingham, AL

Types:

map identification

map notes

Dates:

41) Map Id Records 7 Box 3

FULL BIBLIOGRAPHICAL CITATION OF SOURCE CONTAINING MAP OR PHOTOGRAPH
(call number included if library source):

OWNERSHIP:

perox copy secured courtesy of the library

(Other information attached)

page 2

Types:

map notes

91) Map Id Records 7 Box 3

BI:1:27

MAP AND AERIAL PHOTOGRAPH
IDENTIFICATION

TITLE: "Alabama"

DESCRIPTION:

Date- Ca. 1880

Publisher- J. H. Colton & Co. Lithographer, Surveyor, Geographer (circle)-

Size- 14 1/2" x 16 1/2"

Items on Legend- Railroads, common roads, canals, cities, county towns, villages, P.O., etc.

Scale- 1" = app. 24 mi.

Area Covered- Alabama

Condition- ~~Good~~ ~~Very Good~~ ~~Excellent~~ Good

SIGNIFICANCE: Depicts important towns and roads of the period.

LOCATION (Specific library, courthouse, etc.):
The Rucker Agee Collection
Birmingham Public Library

publisher

Names:

Colton, J. H.

Rucker Agee
Collection

Places:

Birmingham, AL

Types:

map identification

map notes

Dates:

1880

§1) Map Id Records 7 Box 3

FULL BIBLIOGRAPHICAL CITATION OF SOURCE CONTAINING MAP OR PHOTOGRAPH
(call number included if library source):

OWNERSHIP:

perox copy secured courtesy of the library

(Other information attached)

81) Map Id Records 7 Box 3

MAP AND AERIAL PHOTOGRAPH
IDENTIFICATION

81:1:28

TITLE: "State of Alabama"

DESCRIPTION:

Date- ~~ca. 1880~~ ca. 1880 (~~State of Alabama~~) ~~ca. 1880~~

Publisher, Lithographer, Surveyor, Geographer (circle)-
unknown

Size- 30" x 49"

Items on Legend- land offices, county seats, principal
railroads, towns and villages, boundary of counties,
~~the~~ railroad land grant limits

Scale- 1" = 12 miles

Area Covered-
Alabama

Condition-
Good

SIGNIFICANCE:
~~States~~ Map depicting ~~all~~ the
important towns, roads, railroads, canals,
ferries within the region and has
numerous ~~later~~ additions which may
prove significant.

LOCATION (Specific library, courthouse, etc.):
Cartographic Division
~~Cartographic~~ National Archives
copy secured

Cartographic Division

Names:

Alabama

Places:

National Archives

Types:

map identification

Dates:

1880

81) Map Id Records 7 Box 3

FULL BIBLIOGRAPHICAL CITATION OF SOURCE CONTAINING MAP OR PHOTOGRAPH
(call number included if library source):

OWNERSHIP:

(Other information attached)

no additional data

Types:

blank form

81) Map Id Records 7 Box 3

81:1:29

MAP AND AERIAL PHOTOGRAPH
IDENTIFICATION

TITLE: "State of Alabama"

DESCRIPTION:

Date- 1882
Published- Department of the Interior, General Land Office,
N.C. The Fueland, Commissioner
Size- ~~19" x 43"~~ 19" x 43"
Items on Legend- U.S. Land Office, Capital of State, County Seat,
Principal R.R. Stations, Towns and Villages, Rail Road completed,
Rail Road Land Grant Limits
Scale- 1" = 12 mi.
Area Covered- Alabama

Condition- Good

SIGNIFICANCE: ^{detailed township} Large map which shows all the
important towns ~~and~~ villages, and other
items as listed on the legend, excellent for
use in conjunction with plat books.

LOCATION (Specific library, courthouse, etc.):
The Rucker Agee Collection
Birmingham ~~Alabama~~ Public Library

Department of Interior, publisher

Names:

Rucker Agee
Collection

Places:

Birmingham, AL

Types:

map identification

Dates:

1882

#1) Map Id Records
 7 Box 3

MAP AND AERIAL PHOTOGRAPH IDENTIFICATION

81:1:30

TITLE: "Map of the State of Alabama to accompany Ross A. Smith's Alabama State Gazetteer and Business Directory"

DESCRIPTION:

Date- 1884

(Publisher, Lithographer, Surveyor, Geographer (circle))-

G. W. & C. B. Colton & Co.

Size- 14" x 17 1/2"

Items on Legend- railroads, common roads, canals, cities, county towns, P.O.'s

Scale- 1"= app 25 mi.

Area Covered- Alabama

Condition- good

SIGNIFICANCE: township map which may be used to accompany plat books.

LOCATION (Specific library, courthouse, etc.):

Library of Congress Maps Division

copy secured.

Topics:

Alabama State
 Gazeteer

Maps Division
 publisher

publisher
 Maps Division

Names:

Alabama

Colton, C. B.

Colton, G. W.

Smith, Ross A.

Places:

Library of Congress

Types:

author

map identification

map notes

Dates:

1884

81) Map Id Records 7 Box 3

MAP AND AERIAL PHOTOGRAPH
IDENTIFICATION

81:1:31

TITLE: "Rand, McNally & Co.'s Alabama"

DESCRIPTION:

Date- 1884
Publisher, Lithographer, Surveyor, Geographer (circle)-
Rand, McNally & Co.
Size- 14 1/2 "x 21"
Items on Legend-
none
Scale- 1" = app. 17 miles
Area Covered-
Alabama
Condition-
good

SIGNIFICANCE:
fairly detailed topographic
which may be used in conjunction
with the plat books.

LOCATION (Specific library, courthouse, etc.):
Library of Congress
Maps Division
copy secured

Maps Division

Names:

Rand, McNally and
Company

Places:

Library of Congress

Types:

map identification

Dates:

1884

81) Map Id Records 7 Box 3

MAP AND AERIAL PHOTOGRAPH
IDENTIFICATION

81:1:32

TITLE: "Map showing the line of the Alabama, Florida & Atlantic Railway and its Connections"

DESCRIPTION:

Date- 1887
Publisher, Lithographer, Surveyor, Geographer (circle)-
G. W. & C. B. Colton & Co.

Size- 20" x 25"
Items on Legend-
none

Scale- 1" = 35 miles
Area Covered-
Alabama, Georgia, Florida, and South Carolina

Condition-
good

SIGNIFICANCE:
depicts the above railway route and connection and important settlements in the region.

LOCATION (Specific library, courthouse, etc.):
Library of Congress
Maps Division
copy secured

Topics:

Maps Division

surveyor

Maps Division

Names:

Alabama, Florida,
and Atlantic

Railway
Colton, C. B.

Colton, G. W.

Places:

Library of Congress

Types:

map identification

map notes

Dates:

1887

81) Map Id Records 7 Box 3

MAP AND AERIAL PHOTOGRAPH
IDENTIFICATION

BI:1:33

TITLE: "State of Alabama"

DESCRIPTION:

Date- 1889

Publisher, Lithographer, Surveyor, Geographer (circle)-
Dept. of the Interior, General Land Office, W. M.

Size- 27" x 40" Stone Commission

Items on Legend-
U.S. Land Offices
Military Reservations

Scale- 1" = 10 miles

Area Covered-
Alabama

Condition-
Good

SIGNIFICANCE:
very detailed township
map of the state depicting
old sites, structures, roads, etc. of the
region. Excellent for use with
plat books

LOCATION (Specific library, courthouse, etc.):
Library of Congress
Map Division
copy secured.

Topics:

Dept. of Interior,
General Land

Office
Commissioner

Maps Division

Names:

Alabama

Stone, W. M.

Places:

Library of Congress

Types:

map identification

map notes

Dates:

1889

81) Map Id Records 7 Box 3

MAP AND AERIAL PHOTOGRAPH
IDENTIFICATION

81:1:34

TITLE: "Watson and Adams ^{New} Topographical, County,
and Railroad Map of Alabama"

DESCRIPTION:

Date- 1890

Publisher, Lithographer, (Surveyor, Geographer (circle))-
Gaylord Watson & Adams & Co.

Size- 62 1/2" x 72"

Items on Legend-
city, population indicators, county town,
railway, and road.

Scale- 1" = 5 miles

Area Covered-
Alabama

Condition-
good

SIGNIFICANCE: ~~good~~ township map, excellent
for use with plat books

LOCATION (Specific library, courthouse, etc.):
Library of Congress
Maps Division
copy secured

Names:

Watson, Adams and
Company

Watson, Gaylord

Places:

Library of Congress

Types:

map identification

map notes

Dates:

1890

81) Map Id Records 78x3

MAP AND AERIAL PHOTOGRAPH
IDENTIFICATION

BI:1:36

TITLE: "Rand, McNally * & Co's Indexed Atlas of the
World, Map of Alabama"

DESCRIPTION:

Date- 1892

Publisher, Lithographer, Surveyor, Geographer (circle)-
Rand, McNally & Co.

Size- 21" x 28"

Items on Legend-
none

Scale- 1" = app. 12 miles

Area Covered-
Alabama

Condition-
good

SIGNIFICANCE: fairly detailed map of the
TARCOG Region showing almost
all of the important settlements,
road, etc.

LOCATION (Specific library, courthouse, etc.):
Library of Congress
Map Division
copy secured

Maps Division

Names:

Rand, McNally and
Company

Places:

Library of Congress

Types:

map identification

Dates:

1892

91) Map Id Records 7 Box 3

FULL BIBLIOGRAPHICAL CITATION OF SOURCE CONTAINING MAP OR PHOTOGRAPH
(call number included if library source):

OWNERSHIP:

(Other information attached)

no additional data

Types:

blank form

Dates:

1892

91) Map Id Records 7 Box 3

- B1:1: ~~27~~ 37

MAP AND AERIAL PHOTOGRAPH
IDENTIFICATION

TITLE: "Map of the State of Alabama"

DESCRIPTION:

Date- 1895

Publisher, Lithographer, Surveyor, Geographer (circle)-
Compiled by Robert H. Maston from the records of the
General Land Office, Dept. of the Interior.

Size- 24" X 36"

Items on Legend- land office, county seat, military
reservation, light house

Scale- 1" = 12 miles

Area Covered-
Alabama

Condition-
Good

SIGNIFICANCE:

Late 19th century map depicting in detail the location of
contemporary and past settlements and
landmarks of the region, i.e. Fort Hampton,
Fort Deposit, Old Cherokee School, etc.

LOCATION (Specific library, courthouse, etc.):
Dr. Frances C. Roberts
Private Collection

Topics:

Dr. Roberts' private
collection

compiled map

Names:

Maston, Robert H.

Roberts, Dr. Frances

Places:

Huntsville, AL

Types:

map identification

map notes

Dates:

1895

81) Map Id Records 7 Box 3

FULL BIBLIOGRAPHICAL CITATION OF SOURCE CONTAINING MAP OR PHOTOGRAPH
(call number included if library source):

OWNERSHIP:

Copy secured, courtesy of Dr. Roberts.

(Other information attached)

no additional data

Types:

blank form

41) Map Id Records 7 Box 3

B1:1:238

MAP AND AERIAL PHOTOGRAPH
IDENTIFICATION

TITLE: "State of Alabama"

DESCRIPTION:

Date- undated, probably late 19th or early 20th century
Publisher, Lithographer, Surveyor, Geographer (circle)-
unknown

Size- 26" x 48"
Items on Legend- land offices, county seat, principal
railroad stations, towns and villages, county
boundaries, railroads, ~~railroad~~ railroad land grant
Scale- 1" = 10 mi.
Area Covered-
Alabama

Condition-
Good.

SIGNIFICANCE:
Map of the counties, their streams,
and settlements before ~~the~~ ^{TVA} inundations.

LOCATION (Specific library, courthouse, etc.):
Dr. Frances C. Roberts
Private Collection

Dr. Roberts' private collection

Names:

Roberts, Dr. Frances

Places:

Huntsville, AL

Types:

map identification

81) Map Id Records 7 Box 3

FULL BIBLIOGRAPHICAL CITATION OF SOURCE CONTAINING MAP OR PHOTOGRAPH
(call number included if library source):

OWNERSHIP:

Copy secured, courtesy of Dr. Roberts.

(Other information attached)

no additional data

Types:

blank form

81) Map Id Records 7 Box 3

MAP AND AERIAL PHOTOGRAPH
IDENTIFICATION

81:1:39

TITLE: "Tunison's New Railway, Post Office and
Distance Map of Alabama and Georgia"

DESCRIPTION:

Date- 1900
Publisher, Lithographer, Surveyor, Geographer (circle)-
H. G. Tunison
Size- 36"x50"
Items on Legend- towns and city index, and
population indicators
Scale- 1"= app. 10 miles
Area Covered- Alabama + Georgia
Condition- good

SIGNIFICANCE: ~~see~~ depicts towns, roads, railroads,
and a few structures within the area

LOCATION (Specific library, courthouse, etc.):
Library of Congress
Maps Division
copy secured.

Topics:

Maps Division surveyor

Names:

Tunison, H. G. Tunison's railway

Places:

Library of Congress

Types:

map identification map notes

Dates:

1900

81:1:40

71) Map Id Records 7 Box 3

MAP AND AERIAL PHOTOGRAPH
IDENTIFICATION

TITLE: "Alabama"

DESCRIPTION:
Date- 1901
Publisher, Lithographer, Surveyor, Geographer (circle)-
Rand, McNally & Co.
Size- 18" x 26"
Items on Legend- No legend but depicts a location
chart for Alabama towns and railroads.
Scale- 1" = 13 mi.
Area Covered-
Alabama

Condition-
Good.

SIGNIFICANCE:
Very useful in that the map is detailed, ~~for~~
and ~~is~~ fairly accurate, and attempts
to locate all the state's ~~towns~~ settlements
and ~~and~~ railroads.

LOCATION (Specific library, courthouse, etc.):
The Rucker Agee Collection
Birmingham Public Library.

publisher

Names:

Rand, McNally
Company

Rucker Agee
Collection

Places:

Birmingham, AL

Types:

map identification

Dates:

1901

81) Map Id Records 7 Box 3

FULL BIBLIOGRAPHICAL CITATION OF SOURCE CONTAINING MAP OR PHOTOGRAPH
(call number included if library source):

OWNERSHIP: *Copy secured courtesy of the library.*

(Other information attached)

no additional data

Types:

blank form

81) Map Id Records 7 Box 3

81:1:71

MAP AND AERIAL PHOTOGRAPH
IDENTIFICATION

TITLE: "Alabama"

DESCRIPTION:
Date- 1910
Publisher, Lithographer, Surveyor, Geographer (circle)-
Rand, McNally, & Co.
Size- 8 1/2" x 12 1/4"
Items on Legend- None

Scale- 1" = 28 miles app.
Area Covered- Alabama

Condition- Good

SIGNIFICANCE: Map shows the important towns and roads
of the early 20th century.

LOCATION (Specific library, courthouse, etc.):
The Rucker Agee Collection
Birmingham Public Library

publisher

Names:

Rand, McNally
Company

Rucker Agee
Collection

Places:

Birmingham, AL

Types:

map identification

Dates:

1910

81) Map Id Records 7 Box 3

FULL BIBLIOGRAPHICAL CITATION OF SOURCE CONTAINING MAP OR PHOTOGRAPH
(call number included if library source):

OWNERSHIP:

Repro copy secured courtesy of the ~~State~~ library

(Other information attached)

no additional data

Types:

blank form

81) Map Id Records 7 Box 3

B1:1:42

MAP AND AERIAL PHOTOGRAPH
IDENTIFICATION

TITLE: "State of Alabama"

DESCRIPTION:

Date- 1915

Publisher- Lithographer, Surveyor, Geographer (circle)-
Department of the Interior, General Land Office, Clay Tallman,
Commissioner

Size- 18" X 26"

Items on Legend- County seals, county boundaries, ~~settlements~~
cities, towns, villages, U.S. Land Office, National Parks,
bird reservations, military and naval reservations.

Scale- 1" = 12 miles

Area Covered-
Alabama

Condition-
Good

SIGNIFICANCE: Detailed map which lists historic sites ~~and~~
~~points~~ along with contemporary ~~settlements~~ towns
and settlements, i.e. Old Fort Hampton, Old Cherokee
School, etc.

LOCATION (Specific library, courthouse, etc.):
The Rucker Agee Collection
Birmingham Public Library

Commissioner, Dept. of Interior

Names:

Rucker Agee
Collection

Tallman, Clay

Places:

Birmingham, AL

Types:

map identification

map notes

Dates:

1915

91) Map Id Records 7 Box 3

FULL BIBLIOGRAPHICAL CITATION OF SOURCE CONTAINING MAP OR PHOTOGRAPH
(call number included if library source):

OWNERSHIP:

Copy secured courtesy of the library.

(Other information attached)

no additional data

Types:

blank form

81) Map Id Records 7 Box 3

B1:1:7A43

MAP AND AERIAL PHOTOGRAPH
IDENTIFICATION

TITLE: "Post Route map of the State of Alabama
showing Post Offices with the intermediate Distances
on Mail Routes."

DESCRIPTION:

Date- 1917

Publisher, Lithographer, Surveyor, Geographer (circle)-
Postmaster General A.S. Burlison

Size- 31" x 45"

Items on Legend- Explanation of Mail Service: i.e.
six times a week, three times a week, special supply,
mail message, offices discontinued, rural delivery, etc.

Scale- 1 3/4" = 10 mi.

Area Covered-
The State of Alabama

Condition-
Good

SIGNIFICANCE: This map depicts the postal
routes, offices, distances, and almost
everything associated with the service in
Alabama.

LOCATION (Specific library, courthouse, etc.):
The Frank M. Jones Collection
Birmingham

Topics:

Postmaster General

post route map of
Alabama

Names:

Burlison, A. S.

Frank M. Jones
Collection

Places:

Birmingham, AL

Types:

map identification

map notes

Dates:

91) Map Id Records 7 Box 3

FULL BIBLIOGRAPHICAL CITATION OF SOURCE CONTAINING MAP OR PHOTOGRAPH
(call number included if library source):

OWNERSHIP:
Copy secured courtesy of Mr. Jones.

(Other information attached)

no additional data

Types:

blank form

81) Map Id Records 7 Box 3

B1:1:4444

MAP AND AERIAL PHOTOGRAPH
IDENTIFICATION

TITLE: Alabama Park, Parkway & Recreational Area-
Study, Historic Roads and Trails.

DESCRIPTION:

Date- 1939

Publisher, Lithographer, (Surveyor) Geographer (circle)-
Alabama State Department of Conservation in cooperation with
U.S. Department of the Interior National Park Service

Size- 16 1/2" X 23 1/2"

Items on Legend- Route of De Soto, 1540; military expeditions;
Indian trails; and historic roads.

Scale- none

Area Covered-
Alabama

Condition-
Good

SIGNIFICANCE:
Depicts the location of
many historic roads and trails
in Alabama.

LOCATION (Specific library, courthouse, etc.):
The Frank M. Jones Collection
Birmingham

DeSoto's 1540 Indian trails route

Names:

Alabama Parks,
recreational areas

Frank M. Jones
Collection

Places:

Birmingham, AL

Types:

map identification

map notes

Dates:

1939

81) Map Id Records 7 Box 3

B1:1: 45

MAP AND AERIAL PHOTOGRAPH
IDENTIFICATION

TITLE: "Alabama Highways, Route Numbers ~~from~~ prior to
Publication of the 1957 Official Highway Map"

DESCRIPTION:

Date- ca. 1958

Publisher, Lithographer, Surveyor, Geographer (circle)-
unknown

Size- 13 1/2" X 20"

Items on Legend-
none

Scale- none, 1" = app 20 mi.

Area Covered-
Alabama

Condition-
Good

SIGNIFICANCE: important in that the map gives
former route numbers which can assist
in field survey and research.

LOCATION (Specific library, courthouse, etc.):
Dr. Frances C. Roberts
Private Collection

Dr. Frances C. Roberts' private collection

Names:

Alabama highways

Places:

Huntsville, AL

Types:

map identification

Dates:

1958

71) Map Id Records 7 Box 3

FULL BIBLIOGRAPHICAL CITATION OF SOURCE CONTAINING MAP OR PHOTOGRAPH
(call number included if library source):

OWNERSHIP:
Copy secured courtesy of Dr. Roberts.

(Other information attached)

no additional data

Types:

blank form

51) Map Id Records 7 Box 3

31:1:10946

MAP AND AERIAL PHOTOGRAPH
IDENTIFICATION

TITLE: "Alabama Forts, 1700-1838."

DESCRIPTION:

Date- 1959

Publisher, Lithographer, Surveyor, Geographer (circle)-
William H. Jenkins

Size- 11" x 17"

Items on Legend-
No legend

Scale- none

Area Covered-
Alabama

Condition-
good

SIGNIFICANCE:
Map depicts location of forts within
the state.

LOCATION (Specific library, courthouse, etc.):
The Frank H. Jones Collection
Birmingham

Topics:

Alabama Forts 1700-1838 geographer

Names:

Frank M. Jones Collection Jenkins, William H.

Places:

Birmingham, AL

Types:

map identification map notes

Dates:

§1) Map Id Records 7 Box 3

FULL BIBLIOGRAPHICAL CITATION OF SOURCE CONTAINING MAP OR PHOTOGRAPH
(call number included if library source):

OWNERSHIP:

Copy secured, courtesy of Mr. Jones.

(Other information attached)

no additional data

Types:

blank form

81) Map Id Records
7 Box 3

BI:1:1049

MAP AND AERIAL PHOTOGRAPH
IDENTIFICATION

TITLE:

Plat showing U.S. System of Public-Land
surveys, For Title Examiners, Conveyancers, Law and
Engineering Students

DESCRIPTION:

Date- Recent
Publisher, Lithographer, Surveyor, Geographer (circle)-
Lawyers Title Insurance Corporation
Size- 17 1/2" x 11 1/2"
Items on Legend- Instructions and sample illustrations
on the use of the Public-Land surveys in
Alabama
Scale- none
Area Covered-
Alabama
Condition-
good

SIGNIFICANCE:

This chart aids in the use of land surveys. It
defines terms and measures, ~~illustrates~~ illustrates
the use of township, range, and section,
coordination and meridian coordination.

LOCATION (Specific library, courthouse, etc.):

The Frank M. Jones Collection
Birmingham

publisher

Names:

Frank M. Jones
Collection

Lawyers Title
Insurance

Corporation

U. S. Public land
surveys

Places:

Birmingham, AL

Types:

map identification

map notes

91) Map Id Records 7 Box 3

FULL BIBLIOGRAPHICAL CITATION OF SOURCE CONTAINING MAP OR PHOTOGRAPH
(call number included if library source):

OWNERSHIP:

copy secured, courtesy of Mr. Jones.

(Other information attached)

no additional data

Types:

blank form

Frances Cabaniss Roberts Collection: Series 7, Box 3, Folder 1
Dekalb County, Alabama Map and Aerial Photograph Identification

[Contents](#) [Index](#) [About](#)

Table of Contents

[Image 1](#) (r07_03-01-000-5793)
[Image 2](#) (r07_03-01-000-5794)
[Image 3](#) (r07_03-01-000-5795)
[Image 4](#) (r07_03-01-000-5796)
[Image 5](#) (r07_03-01-000-5797)
[Image 6](#) (r07_03-01-000-5798)
[Image 7](#) (r07_03-01-000-0002)
[Image 8](#) (r07_03-01-000-0003)
[Image 9](#) (r07_03-01-000-0004)
[Image 10](#) (r07_03-01-000-0005)
[Image 11](#) (r07_03-01-000-0006)
[Image 12](#) (r07_03-01-000-0007)
[Image 13](#) (r07_03-01-000-0008)
[Image 14](#) (r07_03-01-000-0009)
[Image 15](#) (r07_03-01-000-0010)

[Image 16](#) (r07_03-01-000-0011)
[Image 17](#) (r07_03-01-000-0012)
[Image 18](#) (r07_03-01-000-0013)
[Image 19](#) (r07_03-01-000-0014)
[Image 20](#) (r07_03-01-000-0015)
[Image 21](#) (r07_03-01-000-0016)
[Image 22](#) (r07_03-01-000-0017)
[Image 23](#) (r07_03-01-000-0018)
[Image 24](#) (r07_03-01-000-0019)
[Image 25](#) (r07_03-01-000-0020)
[Image 26](#) (r07_03-01-000-0021)
[Image 27](#) (r07_03-01-000-0022)
[Image 28](#) (r07_03-01-000-0023)
[Image 29](#) (r07_03-01-000-0024)
[Image 30](#) (r07_03-01-000-0025)

[Image 31](#) (r07_03-01-000-0026)
[Image 32](#) (r07_03-01-000-0027)
[Image 33](#) (r07_03-01-000-0028)
[Image 34](#) (r07_03-01-000-0029)
[Image 35](#) (r07_03-01-000-0030)
[Image 36](#) (r07_03-01-000-0031)
[Image 37](#) (r07_03-01-000-0032)
[Image 38](#) (r07_03-01-000-0033)
[Image 39](#) (r07_03-01-000-0034)
[Image 40](#) (r07_03-01-000-0035)
[Image 41](#) (r07_03-01-000-0036)
[Image 42](#) (r07_03-01-000-0037)
[Image 43](#) (r07_03-01-000-0038)
[Image 44](#) (r07_03-01-000-0039)
[Image 45](#) (r07_03-01-000-0040)

[Image 46](#) (r07_03-01-000-0041)
[Image 47](#) (r07_03-01-000-0042)
[Image 48](#) (r07_03-01-000-0043)
[Image 49](#) (r07_03-01-000-0044)
[Image 50](#) (r07_03-01-000-0045)
[Image 51](#) (r07_03-01-000-0046)
[Image 52](#) (r07_03-01-000-0047)
[Image 53](#) (r07_03-01-000-0048)
[Image 54](#) (r07_03-01-000-0049)
[Image 55](#) (r07_03-01-000-0050)
[Table of Contents](#)
[Name & Place Index](#)
[About the Collection](#)

Frances Cabaniss Roberts Collection: Series 7, Box 3, Folder 1
Dekalb County, Alabama Map and Aerial Photograph Identification

[Contents](#) [Index](#) [About](#)

Name & Place Index

Adams, [15](#)
Alabama & west Florida [7](#)
Alabama and Mississippi [18](#)
Alabama Forts 1700-1838 [52](#)
Alabama highways [50](#)
Alabama Parks, recreational areas [49](#)
Alabama State Gazeteer [29](#)
Alabama, Florida, and Atlantic Railway [31](#)
Alabama [9](#), [14](#), [20](#), [21](#), [26](#), [29](#), [32](#)
Asher, [15](#)
Bache, A. D. [14](#)
Birmingham, AL [7](#), [9](#), [15](#), [22](#), [24](#), [28](#), [41](#), [43](#), [45](#), [47](#), [49](#),
[52](#), [54](#)
Browning, [11](#)
Burlison, A. S. [47](#)
Colton's map of Alabama [11](#), [13](#)
Colton, C. B. [13](#), [29](#), [31](#)
Colton, G. W. [13](#), [29](#), [31](#)
Colton, J. H. [24](#)
compiled map [36](#)
county maps [17](#)
Cram's Railroad & Township [19](#)
Cram's railroads [22](#)
Cram, George F. [19](#), [22](#)
Dekalb Co., AL [1](#), [3](#), [4](#), [5](#), [6](#)
Department of Interior Commissioner [21](#)
Dept. of Interior, General Land Office Commissioner [32](#)
Dr. Roberts' private collection [36](#)
Fort Payne, AL [1](#), [3](#), [4](#), [5](#), [6](#)
Frank M. Jones Collection [9](#), [47](#), [49](#), [52](#), [54](#)
geographer [7](#), [15](#), [52](#)
Georgia and Alabama map [15](#)
Georgia and Alabama [17](#)
Gray's map of Alabama [20](#)
Gray, Frank A. [20](#)
Huntsville, AL [12](#), [17](#), [21](#), [36](#), [38](#), [50](#)
Jenkins, William H. [52](#)
Johnson's Georgia and Alabama [12](#)
Johnson, A. J. [12](#)
Johnson, [11](#)
LaTourrette, John [7](#)
Lawyers Title Insurance Corporation [54](#)
Library of Congress, Map Division [18](#)
Library of Congress [11](#), [13](#), [14](#), [19](#), [29](#), [30](#), [31](#), [32](#), [33](#),
[34](#), [40](#)
Library's Heritage Room [21](#)
Map Division [13](#), [14](#), [19](#)
map includes Huntsville [7](#)
Maps Division [11](#), [29](#), [29](#), [31](#), [31](#), [32](#), [40](#)
Maston, Robert H. [36](#)
Mitchell, S. Augustus [17](#)
Moore, S. E. [9](#)
National Archives [26](#)
New York [12](#)
north Alabama only [13](#)
post route map of AL and MS [18](#)
post route map of Alabama [47](#)
Postmaster General [47](#)
publisher [11](#), [13](#), [17](#), [18](#), [19](#), [22](#), [29](#), [29](#)
Rand, McNally and Company [30](#), [34](#)
Rand, McNally Company [41](#), [43](#)
Roberts, Dr. Frances [36](#), [38](#)
Rucker Agee Collection [7](#), [15](#), [22](#), [24](#), [28](#), [41](#), [43](#), [45](#)
Smith, Ross A. [29](#)
Stone, W. M. [32](#)
surveyor, superintendent [14](#)
surveyor [31](#), [40](#)
Tallman, Clay [45](#)
township map of Alabama [22](#)
Tunison's railway [40](#)
Tunison, H. G. [40](#)
U. S. Construction survey [14](#)
U. S. Post Office Department [18](#)
U. S. Public land surveys [54](#)
Watson, Adams and Company [33](#)
Watson, Gaylord [33](#)
Williamson, J. A. [21](#)

Frances Cabaniss Roberts Collection

Preferred Citation: Frances Cabaniss Roberts Collection, Archives and Special Collections, M. Louis Salmon Library, University of Alabama in Huntsville, Huntsville, AL.

Collection Scope and Content: The Collection of 114 Linear ft. includes a total of 156 Archival Boxes. The Frances Cabaniss Roberts collection covers the historical records of the Cabaniss Roberts family. This collection contains extensive correspondence records of the Cabaniss Roberts family circa 1830 to 1930.

Archives/Special Collections Access Restrictions: None

Conditions Governing Use: This material may be protected under U. S. Copyright Law (Title 17, U.S. Code) which governs the making of photocopies or reproductions of copyrighted materials. You may use the digitized material for private study, scholarship, or research. Though the University of Alabama in Huntsville Archives and Special Collections has physical ownership of the material in its collections, in some cases we may not own the copyright to the material. It is the patron's obligation to determine and satisfy copyright restrictions when publishing or otherwise distributing materials found in our collections.

Provenance: Gift of Johanna Shields on October 28, 2006.



**The UAH Archives and Special Collections
M. Louis Salmon Library**