

Frances Cabaniss Roberts Collection: Series 7, Box 6, Item 21

Skyline Farms - Jackson Co. Site #22

Image 1 r07_06-00-021-0121 [Contents](#) [Index](#) [About](#)

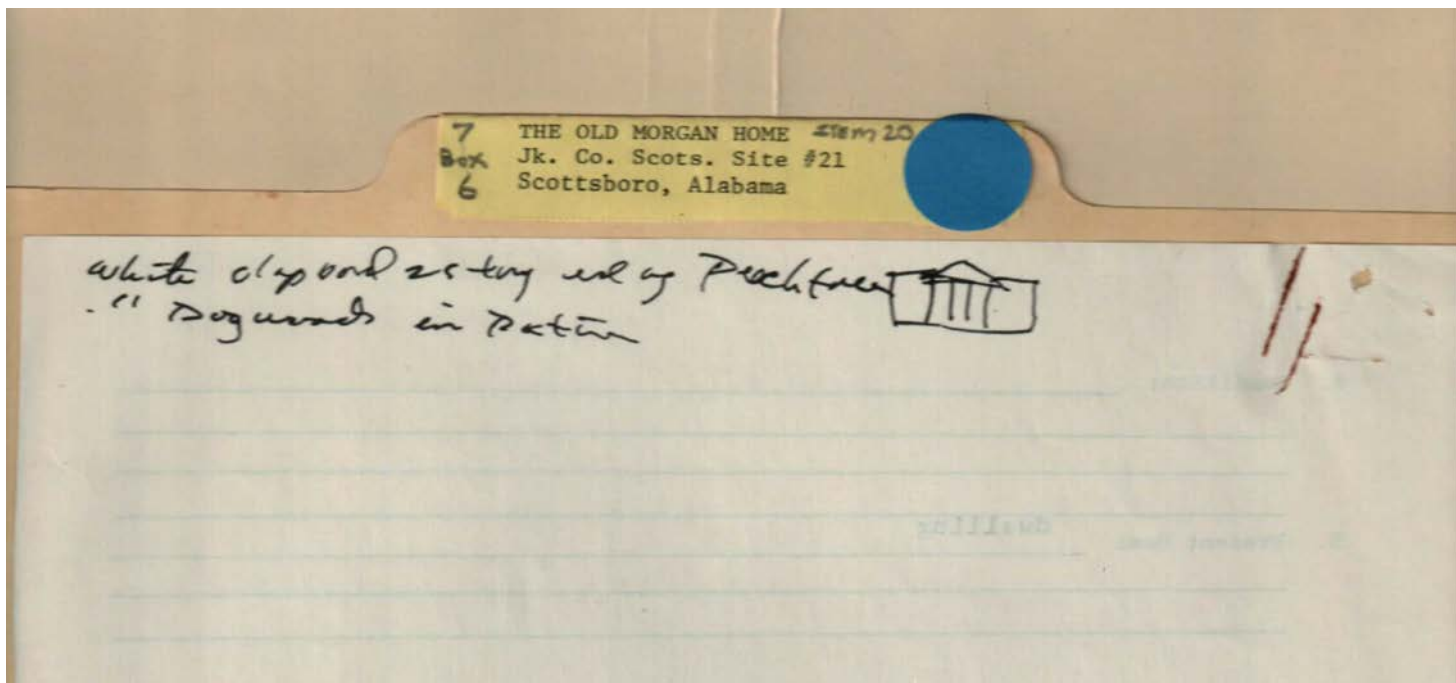

Types:

memo

SKYLINE FARMS 7 Box 6
Jk. Co. Site #22 ITEM
Sec. 5,6; T3S; R5E 21

TARCOG HISTORICAL SURVEY
Final Report Form

Make your answers as concise as possible.

Number as appears on your county map 22

1. Name of site or structure SKYLINE FARMS

2. Location of site or structure (including township, range and section number, and which quadrant of section if known) Turn left off hwy 72 from Huntsville on to hwy 79; follow 79 up mountain S-5; T-3; R-4E

3. Description Community with original store, school and old government office buildings. Original houses still standing; some unmodified.

4. Historical significance of site or structure if known This was an experimental housing project of Franklin D. Roosevelt's New Deal period. It was the only one of it's kind in the nation. The land was divided into 200 forty-acre plots and it was homesteaded by specially chosen farmers. The project was later abandoned and the houses and land sold to individuals. (See HS-1, No.22)

Names:

Roosevelt, Franklin
D.

Skyline Farms

TARCOG Historical
Survey

Places:

Jackson County, AL

Types:

memo

Frances Cabaniss Roberts Collection: **Series 7, Box 6, Item 21**

Skyline Farms - Jackson Co. Site #22

Image 3 r07_06-00-021-0123 [Contents](#) [Index](#) [About](#)

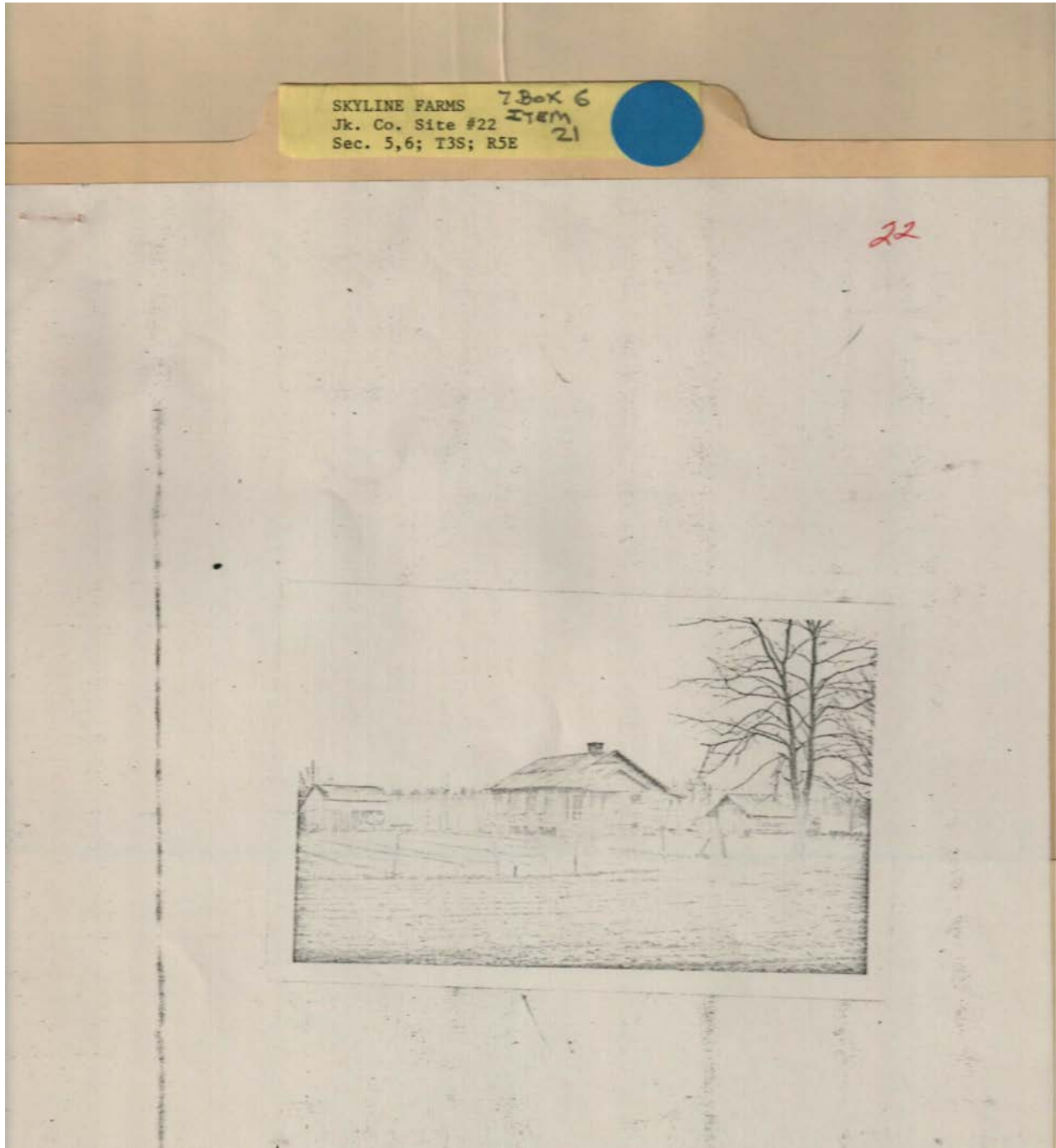

Names:

Skyline Farms

Places:

Jackson County, AL

Types:

photograph

Frances Cabaniss Roberts Collection: **Series 7, Box 6, Item 21**

Skyline Farms - Jackson Co. Site #22

Image 4 r07_06-00-021-0124 [Contents](#) [Index](#) [About](#)

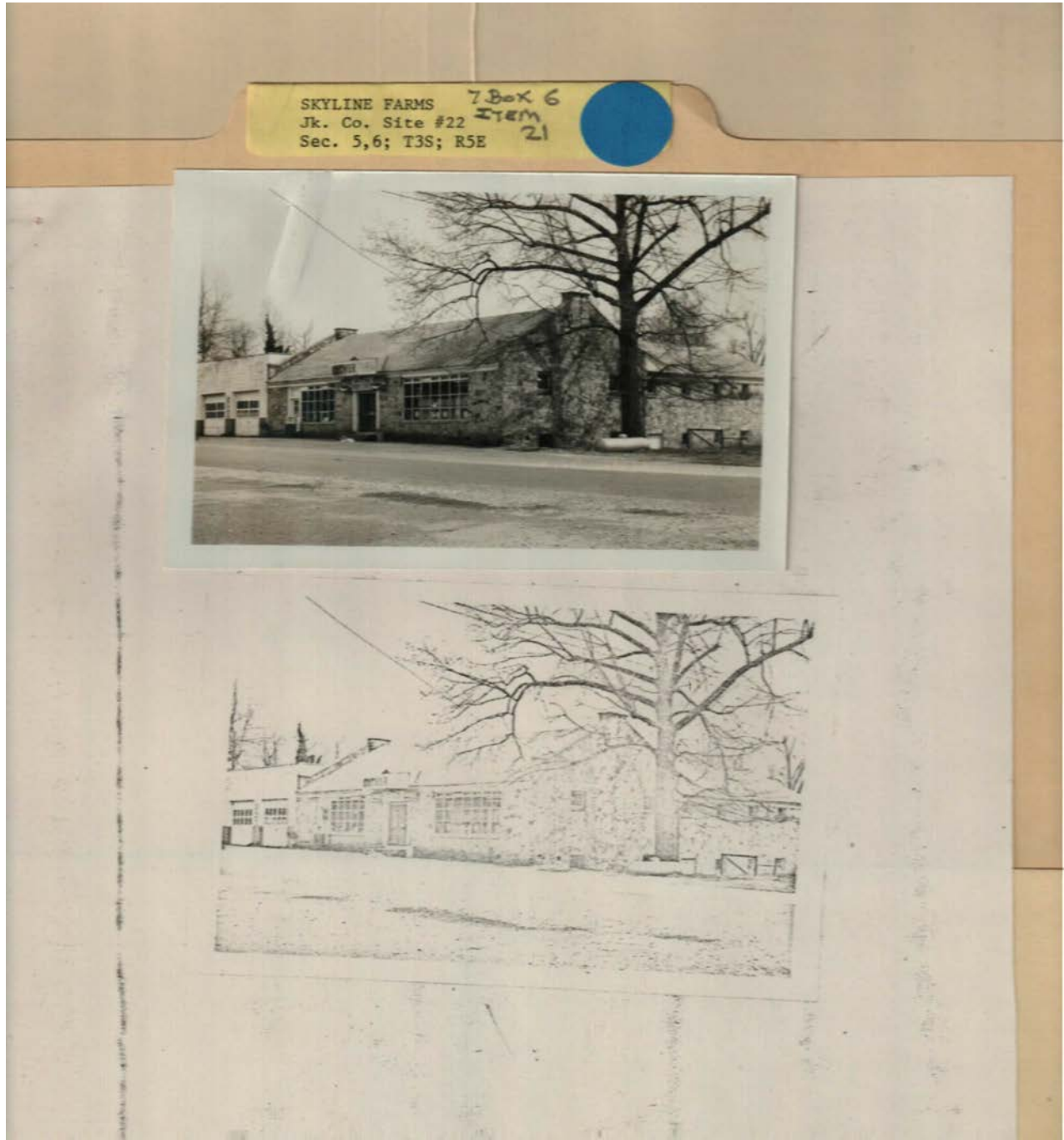

Names:

Skyline Farms

Places:

Jackson County, AL

Types:

photograph

Frances Cabaniss Roberts Collection: Series 7, Box 6, Item 21

Skyline Farms - Jackson Co. Site #22

Image 5 r07_06-00-021-0125 [Contents](#) [Index](#) [About](#)

SKYLINE FARMS 7 Box 6
Jk. Co. Site #22 Item 21
Sec. 5,6; T3S; R5E

TARCOG
HISTORICAL SURVEY PHOTOGRAPH RECORD

County: Jackson

Field Surveyors' Names: Booth

I. Information on Photograph

Date of Photograph: 4/3/74 Photographer: Cottney
Booth

Roll Number: _____ View Description: typical Homestead
Exposure Number: _____ in community

II. Information on Site

Place Number on Map (Blue Ink): 22
(Copied from number used in recording it on appropriate County Highway Map)

Historical Notes Number (Red Ink): 22
(If there is a historical notes form filled in for this place, write it in the photograph number in the upper right-hand corner of this form in space provided).

Location (Word Description): on Cumberland Plateau north of U.S. 72
on Hwy 79 go to top of plateau and area is to the
west.

Owner or Occupant: unknown
(Name, if known)

Address: _____

TYPE of Structure: () House () Outbuilding () Commercial
() Barn () Industrial (x) Other, describe
check one or more typical Homestead and the surrounding

Apparent period of construction: () Federal
() Greek Revival
() Mid-19th Century
later () Latter 19th Century
() Early 20th Century

Apparent period of Additions: () Federal
(if appropriate) () Greek Revival
() Mid-19th Century
() Latter 19th Century
() Early 20th Century
() Later 20th Century (modern)

III. Remarks and Sketches if appropriate: This was in FDR Project.

Date of completion: 4/3/74 Form HS-2

Names:

Booth,

Cottney,

Skyline Farms

Places:

Jackson County, AL

Types:

survey

Dates:

Apr 03, 1974

Frances Cabaniss Roberts Collection: Series 7, Box 6, Item 21

Skyline Farms - Jackson Co. Site #22

Image 6 r07_06-00-021-0126 [Contents](#) [Index](#) [About](#)

SKYLINE FARMS 7 Box 6
Jk. Co. Site #22 Item 21
Sec. 5,6; T3S; R5E

TARCOG
ARCHITECTURAL--HISTORICAL NOTES
FIELD SURVEYOR
RECORDING FORM

County: JACKSON

Field Surveyors' Names: Booth
Cottney

Historical Notes Number: 22-22
(Red Ink)

Photograph Record Number:
(Blue Ink)

1. Name: SKYLINE FARMS

2. Location: on Cumberland Mountain up from Scottsboro. Turn left (coming from Huntsville) off hwy 72 (between Larkinsville and Scottsboro) on to hwy 79. Follow 79 up the mountain.

3. Owner of Property:

4. Geographical Data:

5. Acreage:

6. Classification: site

7. Integrity:

Form HS-1
p. 1

Names:

Booth,

Cottney,

Places:

Jackson County, AL

Types:

survey

Frances Cabaniss Roberts Collection: Series 7, Box 6, Item 21

Skyline Farms - Jackson Co. Site #22

Image 7 r07_06-00-021-0127 [Contents](#) [Index](#) [About](#)

SKYLINE FARMS
 Jk. Co. Site #22
 Sec. 5,6; T3S; R5E

7 Box 6
 Item 21

8. Condition: _____

9. Present Use: (community) _____

10. Skyline Farms was an experimental project of Franklin Roosevelt's NEW DEAL. ~~xxxxxx~~ About 1932 the Federal Government ~~xxxxxx~~ bought 6,000 acres ~~xxxxxx~~ of land on a remote plateau of Cumberland Mountain. They later purchased an additional 5,000 acres. The land was divided into 200 forty acre plots. A house was to be constructed on each plot and a "Class 2" farmer (meaning a farm with no visible means of support) was to homestead the land. In 1934 the chosen settlers began the task of building a road to the site. A kitchen and bunkhouse were constructed. The houses were started and the land was cleared. Every family was to have 40 acres, a house, a mule, wagon and farming implements furnished. They also furnished a sewing machine, a "pressure cooker" and other ~~xxxxxx~~ needed items for the women. The first year's crop was made with oxen instead of mules. A school, commissary, and recreation center were built. The community was originally called Cumberland Farms. The "reek store" has a corner stone which bears the date of 1936. It was the "commissary" where the farmers purchased their food supplies and were given "dividends". Eleanor Roosevelt personally invited a square dance group from this community to the White House to perform for one of her garden clubs. (Do you suppose she wanted to show off her hillbillies??!!). The experiment finally failed or was abandoned by the government and the land was sold to private individuals in 1945. The homesteaders, with the exception of a few, were not even allowed to buy their homes. The story is very reminiscent of the slaves who were promised "40 acres and a mule" at the end of the civil war.

Ref: Personal knowledge of Christine Sumner whose father worked for the Federal Government during the building of Skyline Farms
 "Pictorial Walks Thru Old High Jackson", pp.102-104

12. Sketches of structure or site when applicable: _____

Date of Completion: _____

Form HS-1
P. 2

Names:

Roosevelt, Eleanor

Roosevelt, Franklin
D.

Skyline Farms
Sumner, Christine

Places:

Jackson County, AL

Types:

survey

Frances Cabaniss Roberts Collection: Series 7, Box 6, Item 21

Skyline Farms - Jackson Co. Site #22

Image 8 r07_06-00-021-0128 [Contents](#) [Index](#) [About](#)

SKYLINE FARMS 7 Box 6
Jk. Co. Site #22 Item 21
Sec. 5,6; T3S; R5E

TARCOG
HISTORICAL SURVEY PHOTOGRAPH RECORD

County: Jackson

Field Surveyors' Names: Booth

I. Information on Photograph

Photographer: Cottney
Booth

Date of Photograph: 4/3/74

Roll Number: _____

Exposure Number: _____

View Description: typical Homestead
in community

II. Information on Site

Place Number on Map (Blue Ink): 36
(Copied from number used in recording it on appropriate County Highway Map)

Historical Notes Number (Red Ink): 36
(If there is a historical notes form filled in for this place, write it in the photograph number in the upper right-hand corner of this form in space provided).

Location (Word Description): on Cumberland Plateau north of U.S. 72
on Hwy 79 go to top of plateau and area is to the west.

Owner or Occupant: Unknown
(Name, if known)

Address: _____

TYPE of Structure: () House () Outbuilding () Commercial
() Barn () Industrial (x) Other, describe
(where appropriate, check one or more) typical Homestead in the community

Apparent period of construction: () Federal
() Greek Revival
() Mid-19th Century
() Latter 19th Century
() Early 20th Century

Apparent period of Additions: () Federal
() Greek Revival
() Mid-19th Century
() Latter 19th Century
() Early 20th Century
() Later 20th Century (modern)

III. Remarks and Sketches if appropriate: This was an FDR Project.

Date of completion: 4/3/74

Form HS-2

Names:

Booth,

Cottney,

Skyline Farms

Places:

Jackson County, AL

Types:

survey

Dates:

Apr 03, 1974

Frances Cabaniss Roberts Collection: Series 7, Box 6, Item 21

Skyline Farms - Jackson Co. Site #22

Image 9 r07_06-00-021-0129 [Contents](#) [Index](#) [About](#)

SKYLINE FARMS 7 Box 6
Jk. Co. Site #22 ITEM
Sec. 5,6; T3S; R5E 21

TARCOG
ARCHITECTURAL--HISTORICAL NOTES
FIELD SURVEYOR
RECORDING FORM

County: JACKSON
Field Surveyors' Names: Booth
Cottrell
Historical Notes Number: 22
(Red Ink)
Photograph Record Number: 171-172
(Blue Ink)

1. Name: SKYLINE FARMS

2. Location: on Cumberland Mountain up from Scottsboro. Turn left (coming from Huntsville) off hwy 72 (between Larkinsville and Scottsboro) on to hwy 79. Follow 79 up the mountain.

3. Owner of Property:

4. Geographical Data:

5. Acreage:

6. Classification: site

7. Integrity:

Form HS-1
p. 1

Names:

Skyline Farms

Places:

Jackson County, AL

Types:

survey

SKYLINE FARMS 7Box 6
 Jk. Co. Site #22 Item 21
 Sec. 5,6; T3S; R5E

8. Condition: _____

9. Present Use: (community) _____

10. Skyline Farms was an experimental project of Franklin D. Roosevelt's NEW DEAL. ~~xxxxx~~ About 1932 the Federal Government ~~xxxxx~~ bought 8,000 acres ~~xxxxx~~ of land on a remote plateau of Cumberland Mountain. They later purchased an additional 5,000 acres. The land was divided into 200 forty acre plots. A house ~~was to be constructed on each plot and a "Class 2" farmer (meaning a farmer with no visible means of support) was to homestead the land.~~ In 1934 the chosen settlers began the task of building a road to the site. A kitchen and bunkhouse ~~es were constructed. The houses were started and the land was cleared.~~ Every family was to have 40 acres, a house, a mule, wagon and farming implements furnished. They also furnished a sewing machine, a "pressure cooker" and other ~~Architectural Description: needed items for the women. The first year's crop was made with oxen instead of mules. A school, commissary, and recreation center were built. The community was originally called Cumberland Farms. The "Reek Store" has a corner stone which bears the date of 1934. It was the "commissary" where the farmers purchased their food supplies and were given "dividends". Eleanor Roosevelt personally invited a square dance group from this community to the White House to perform for one of her garden clubs. (Do you suppose she wanted to show off her hillbillies??!!). The experiment finally failed or was abandoned by the government and the land was sold to private individuals in 1945. The homesteaders, with the exception of a few, were not even allowed to buy their homes. The story is very reminiscent of the slaves who were promised "40 acres and a mule" at the end of the civil war.~~

Ref: Personal knowledge of Christine Sumner whose father worked for the Federal Government during the building of Skyline Farms
 "Pictorial Walks Thru Old High Jackson", pp.102-104

12. Sketches of structure or site when applicable:

Date of Completion: _____

Form HS-1
p. 2

Frances Cabaniss Roberts Collection: Series 7, Box 6, Item 21

Skyline Farms - Jackson Co. Site #22

[Contents](#) [Index](#) [About](#)

Table of Contents

[Image 1](#) (r07_06-00-021-0121)

[Image 2](#) (r07_06-00-021-0122)

[Image 3](#) (r07_06-00-021-0123)

[Image 4](#) (r07_06-00-021-0124)

[Image 5](#) (r07_06-00-021-0125)

[Image 6](#) (r07_06-00-021-0126)

[Image 7](#) (r07_06-00-021-0127)

[Image 8](#) (r07_06-00-021-0128)

[Image 9](#) (r07_06-00-021-0129)

[Image 10](#) (r07_06-00-021-0130)

[Table of Contents](#)

[Name & Place Index](#)

[About the Collection](#)

Frances Cabaniss Roberts Collection: Series 7, Box 6, Item 21

Skyline Farms - Jackson Co. Site #22

[Contents](#) [Index](#) [About](#)

Name & Place Index

Booth, [5](#), [6](#), [8](#)

Cottney, [5](#), [6](#), [8](#)

Jackson County, AL [2](#), [3](#), [4](#), [5](#), [6](#), [7](#), [8](#), [9](#)

Roosevelt, Eleanor [7](#)

Roosevelt, Franklin D. [2](#), [7](#)

Skyline Farms [2](#), [3](#), [4](#), [5](#), [7](#), [8](#), [9](#)

Sumner, Christine [7](#)

TARCOG Historical Survey [2](#)

Frances Cabaniss Roberts Collection

Preferred Citation: Frances Cabaniss Roberts Collection, Archives and Special Collections, M. Louis Salmon Library, University of Alabama in Huntsville, Huntsville, AL.

Collection Scope and Content: The Collection of 114 Linear ft. includes a total of 156 Archival Boxes. The Frances Cabaniss Roberts collection covers the historical records of the Cabaniss Roberts family. This collection contains extensive correspondence records of the Cabaniss Roberts family circa 1830 to 1930.

Archives/Special Collections Access Restrictions: None

Conditions Governing Use: This material may be protected under U. S. Copyright Law (Title 17, U.S. Code) which governs the making of photocopies or reproductions of copyrighted materials. You may use the digitized material for private study, scholarship, or research. Though the University of Alabama in Huntsville Archives and Special Collections has physical ownership of the material in its collections, in some cases we may not own the copyright to the material. It is the patron's obligation to determine and satisfy copyright restrictions when publishing or otherwise distributing materials found in our collections.

Provenance: Gift of Johanna Shields on October 28, 2006.



**The UAH Archives and Special Collections
M. Louis Salmon Library**